



BE-EXP-1102 (COB)

EXP-1102(COB)

The 1102 (COB) fixture withstands extreme temperatures, explosion and fire hazards, as well as flammable gases and vapours. This driverless LED fixture can withstand temperatures up to 100°C with a CID1/CIID2 and CID2 classification ratings.

Ideal for high heat environments, petrochemical complexes, painting facilities, offshore platforms, oil and gas complexes, and more.

KEY FEATURES:

- CID1 Group B, C, D
- CIID2 Group F, G
- CID2 Group A, B, C, D
- Temperature Range of -40°C ~ +100°C
- 6KV Surge Protection Built-In
- Various Mounting Options
- Driverless Hazardous LED
- L70 Lifespan of 60,000 Hours



SPECIFICATIONS

Luminous Efficacy	100lm/W
CCT	3000K, 5000K (Standard)
CRI	>Ra70 (5000K), Ra80 (3000K)
Beam Angle	>110°
Input Voltage	120V / 277V / 480V
IP Rating	IP67
L70 Lifespan	60,000 Hours
Operating Temp.	-40°C up to +100°C (60W-120-277V) -40°C up to +85°C (60W-480V & 80W-120-277V) -40°C up to +65°C (80W-480V & 100W-120-277V)
Warranty	65°C and Below - 5 Year Warranty 65°-85°C - 2 Year Warranty 86°-100°C - 1 Year Warranty
Certifications	UL, cUL
Classifications	CID1 / CIID2 CID2

LUMENS	WATTAGE	EQUIVALENT
10,000lm	100W	250W
8,000lm	80W	180W
6,000lm	60W	150W



Mounting Options

ADJUSTABLE WALL/HANGING/ROTATABLE MOUNT (WHR)

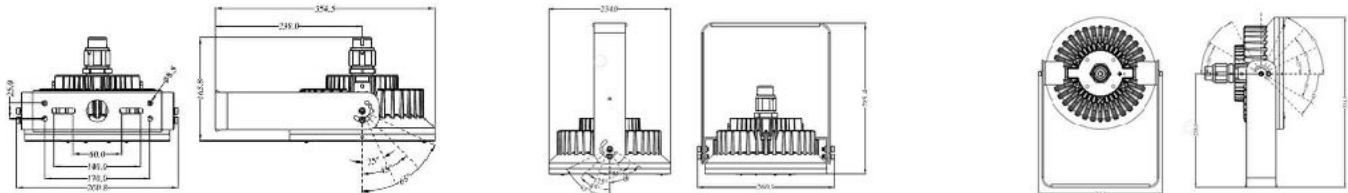

CEILING MOUNT (C90)

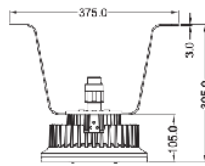

STANCHION MOUNT (S25)

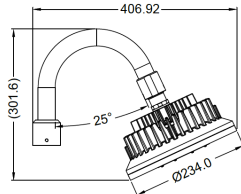

STANCHION MOUNT(S90)

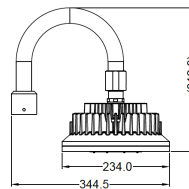

PENDANT MOUNT (P90)

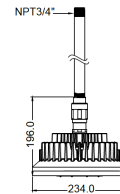

Fixture Ordering Matrix

Product Name	Wattage	Input Voltage	CCT	Classification	Options
BE-EXP-1102 (COB)	60W	120V	3000K	CIDI / CIID2	WHR -Adjustable Wall/Hanging/Rotatable Mount P90 -Pendant Mount C90 -Ceiling Mount S25/90 -Stanchion Mount 25°/90° DIFF -Diffuser SC -Safety Cable SGS -Surge Suppressor
	80W	277V	5000K (Standard)		
	100W	480V		CID2	

Example: BE-EXP-1102(COB)-60W-120V-5000K-CID1-WHR

Dimensions & Shipping Information

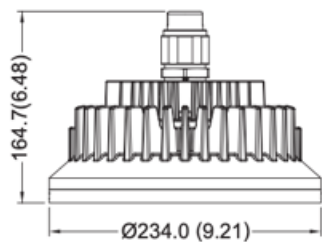

Dimension in Millimeters (inches)

Fixture Weight: 12.1 lbs

Fixture w/ Bracket Weight:

WHR: 16.5 lbs

P90: 13.2 lbs

C90: 16.6 lbs

S25/S90: 14.1 lbs



Canada

Canadian Purchase Orders ship from our Canadian warehouse located at:

1178 Bighorn Ave
Pincher Creek, AB T0K 1W0
Canada



USA

USA Purchase Orders ship from our US warehouse located at:

910 S. Industrial Park Road
Shelby, MT 59474
USA



SUPPORT:

We sell exclusively through distributors. If you are a manufacturing plant, we are happy to work with you and your supplier of choice.

Our lead time on standard items is 5-7 business days.

For IES Files, lighting layouts or further questions, please contact one of our sales representatives.