



## EXP-1102

The 1102 fixture withstands extreme temperatures, explosion and fire hazards, as well as flammable gases and vapours. This driverless LED fixture can withstand temperatures up to 85°C with a CID2 classification rating.

Ideal for high heat environments, petrochemical complexes, painting facilities, offshore platforms, oil and gas complexes, and more.

### KEY FEATURES:

- CID2 Group A, B, C, D
- Temperature Rating of -40°C ~ +85°C
- 6KV Surge Protection Built-In
- Various Mounting Options
- Driverless Hazardous LED
- L70 Lifespan of 60,000 Hours

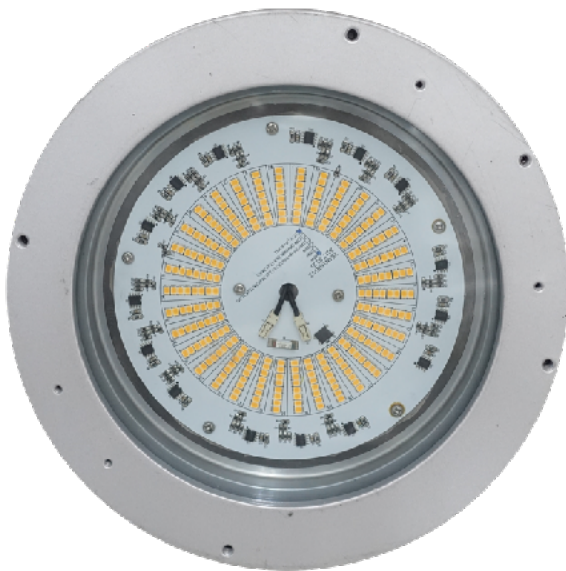

### SPECIFICATIONS

<b>Luminous Efficacy</b>	100lm/W
<b>CCT</b>	3000K, 5000K (Standard)
<b>CRI</b>	>Ra70 (5000K), Ra80 (3000K)
<b>Beam Angle</b>	>110°
<b>Input Voltage</b>	120V / 277V
<b>IP Rating</b>	IP67
<b>L70 Lifespan</b>	60,000 Hours
<b>Operating Temp.</b>	-40°C up to +85°C (65W & 75W) -40°C up to +65°C (95W)
<b>Warranty</b>	65°C and Below - 5 Year Warranty 65°-85°C - 2 Year Warranty
<b>Certifications</b>	UL, cUL
<b>Classifications</b>	CID2 Group A, B, C, D

LUMENS	WATTAGE	EQUIVALENT
9,500lm	95W	250W
7,500lm	75W	180W
6,500lm	65W	150W



**Mounting Options**

**ADJUSTABLE WALL/HANGING/ROTATABLE MOUNT (WHR)**

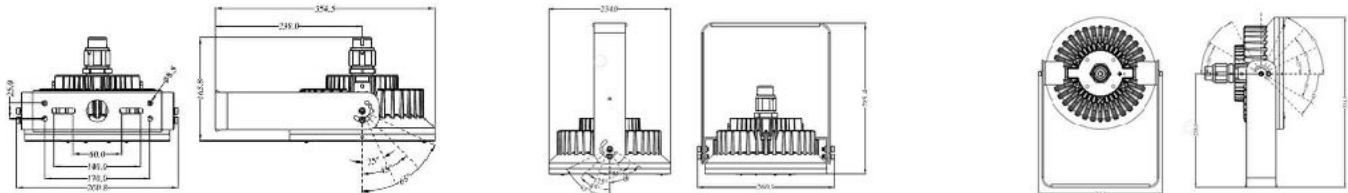

**CEILING MOUNT (C90)**

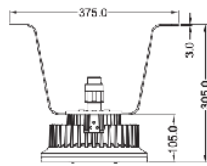

**STANCHION MOUNT (S25)**

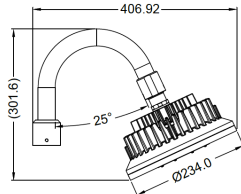

**STANCHION MOUNT(S90)**

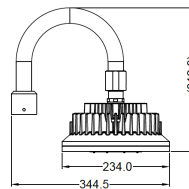

**PENDANT MOUNT (P90)**

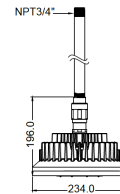

**Fixture Ordering Matrix**

Product Name	Wattage	Input Voltage	CCT	Classification	Options
BE-EXP-1102	65W	120V	3000K	CID2	<b>WHR</b> Adjustable Wall/Hanging/Rotatable Mount <b>P90</b> Pendant Mount <b>C90</b> Ceiling Mount <b>S25/90</b> Stanchion Mount 25°/90° <b>DIFF</b> Diffuser <b>SC</b> Safety Cable <b>SGS</b> Surge Suppressor
	75W	277V	5000K (Standard)		
	95W				

Example: BE-EXP-1102-65W-120V-5000K-CID2-WHR

**Dimensions & Shipping Information**

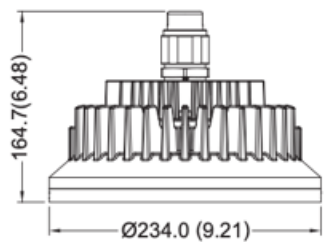

Dimension in Millimeters (inches)

**Fixture Weight:** 12.1 lbs

**Fixture w/ Bracket Weight:**

WHR: 16.5 lbs

P90: 13.2 lbs

C90: 16.6 lbs

S25/S90: 14.1 lbs



**Canada**

Canadian Purchase Orders ship from our Canadian warehouse located at:

1178 Bighorn Ave  
Pincher Creek, AB T0K 1W0  
Canada



**USA**

USA Purchase Orders ship from our US warehouse located at:

910 S. Industrial Park Road  
Shelby, MT 59474  
USA



**SUPPORT:**

**We sell exclusively through distributors.** If you are a manufacturing plant, we are happy to work with you and your supplier of choice.

Our lead time on standard items is 5-7 business days.

For IES Files, lighting layouts or further questions, please contact one of our sales representatives.